

# TARGETTI

## SATURN MINI

### Professional Inground LED Fixture

**Concept:** Mini recessed ingrade LED fixture.

**Materials:** Anodized polished aluminum body.

**Trim:** Front made entirely of screen-printed, opal white 4mm thick glass.

**Optic:** High Efficiency LED Emitter. Precision optic system with PMMA lenses for the wide flood version.

**Mounting:** Recessed mounting with installation sleeve (required). Drive over rated to 20kN.

**Driver:** Remote Class 2, 120V-277VAC power supply required, see page 2 for options.

**Installation:** Flush installation sleeve with adjustable collar for precision finished floor mounting 2.76"H, Ø1.58" sleeve . Raised installation mount includes 2.36"H, Ø1.34" sleeve. Pre-cabled with 2ft direct burial 18-2ga cable for connection to remote power supply.

**Wattage:** 3W

**Color Temperature:** 3000°K / 4000°K

**CRI:** 84 CRI standard, 90 CRI available on request.

**Lumens:** 3000°K 4000°K

Wide Flood 122° = 11Lm 12Lm

**Lumen Maintenance (L70):** 50,000hrs

*Calculation for LED fixtures are based on measurements that comply with IES LM-80.*

**Voltage:** 24VDC

**IP:** IP67 rated

**Load Rating:** Resistant to static loads up to 20KN in flush mounted cement and pavement installations.

**Certifications:** cULus Class 2 Wet Location Listed

Tested in accordance with LM-79-08

**Warranty:** 5 year limited warranty

\* Up to 1 METER DEPTH of water for up to a maximum of 30 MINUTES



PRODUCT CODE	DRIVER	LENS	WATTAGE	COLOR TEMP	VOLTAGE	+	INSTALLATION
SAM – SATURN Mini	RP – Remote Driver	WF – Wide Flood 122°	L1 – 3W	30 – 3000K	24 – 24VDC		Required (See Pg 2)
			40 – 4000K				

### Views

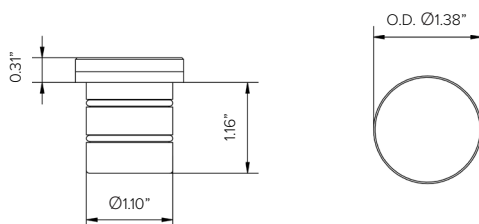

# TARGETTI

## SATURN MINI

INSTALLATION (REQUIRED)	
<b>1E3178</b>	Installation sleeve. Flush installation sleeve with adjustable collar for precision finished floor mounting 2.76"H, Ø1.58". Raised installation mount 2.36"H, Ø1.34". <b>(REQUIRED)</b>

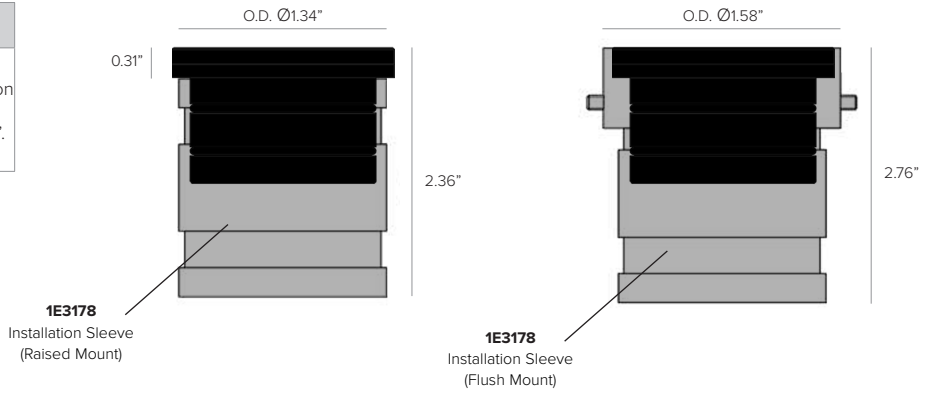

Power Supply (REQUIRED)	Type	Wattage	Input/Output Voltage	Dimmable	IP Rating	Output	Dimensions
<b>DEL60PWM</b>	ELECTRONIC PWM DRIVER STANDALONE, <b>UL LISTED ENCLOSURE PROVIDED BY OTHERS</b>	60W	120-277V / 24V	0-10V/PWM 10%	IP67	UR CLASS 2	5.9" X 2.09" X 1.38"
<b>DEL90PWM</b>	ELECTRONIC PWM DRIVER STANDALONE, <b>UL LISTED ENCLOSURE PROVIDED BY OTHERS</b>	90W	120-277V / 24V	0-10V/PWM 10%	IP67	UR CLASS 2	6.73" X 2.48" X 1.48"
<b>DEDDxxx</b> consult factory	ELECTRONIC 0-10V DRIVER STANDALONE, <b>UL LISTED ENCLOSURE PROVIDED BY OTHERS</b>	consult factory	120-277V / 24V	0-10V DIMMING 0.1%	N/A	UR CLASS 2	consult factory
<b>DELV40124D</b>	ELECTRONIC LOW VOLTAGE TRANSFORMER	40W	120-277V / 24V	PHASE (120V ONLY) /0-10V DIMMING 10%	IP66 / NEMA4 ENCLOSURE	UL CLASS 2	11" x 4" x 2.21" <sup>1</sup>
<b>DELV60124D</b>	ELECTRONIC LOW VOLTAGE TRANSFORMER	60W	120-277V / 24V	PHASE (120V ONLY) /0-10V DIMMING 10%	IP66 / NEMA4 ENCLOSURE	UL CLASS 2	11" x 4" x 2.21" <sup>1</sup>
<b>DELV96124D</b>	ELECTRONIC LOW VOLTAGE TRANSFORMER	96W	120-277V / 24V	PHASE (120V ONLY) /0-10V DIMMING 10%	IP67 / NEMA4 ENCLOSURE	UL CLASS 2	11" x 4" x 2.21" <sup>1</sup>
<b>DELX601241CPWM</b>	ELECTRONIC PWM DRIVER	60W	120-277V / 24V	0-10V/PWM 10%	IP67 / NEMA3R ENCLOSURE	UL CLASS 2	10" x 10" x 4" <sup>1</sup>
<b>DELX901241CPWM</b>	ELECTRONIC PWM DRIVER	90W	120-277V / 24V	0-10V/PWM 10%	IP67 / NEMA3R ENCLOSURE	UL CLASS 2	10" x 10" x 4" <sup>1</sup>
<b>DELX1802242CPWM</b>	ELECTRONIC PWM DRIVER	2X90W	120-277V / 24V	0-10V/PWM 10%	IP67 / NEMA3R ENCLOSURE	UL CLASS 2	12" x 12" x 4" <sup>1</sup>
<b>DELX2703243CPWM</b>	ELECTRONIC PWM DRIVER	3X90W	120-277V / 24V	0-10V/PWM 10%	IP67 / NEMA3R ENCLOSURE	UL CLASS 2	12" x 12" x 4" <sup>1</sup>

<sup>1</sup> Dimensions include enclosure with mounting bracket.

\* Constant voltage drivers 50/60HZ, voltage regulated with short circuit protection. Operating temperature -40 C- 80° C

\* Installation of power supply must be compliant to Class 2 installation standards. Refer to NEC and local building code requirements.

\* Consult factory for additional driver options (ie: DMX, DALI, wattage, size, shape, Lutron, ELDO, or others).

### MAX FIXTURES PER DRIVER

		Fixture Wattage						
		3W	4W	5W	6W	9W	10W	14W
Driver Wattage	40W	10	8	6	5	3	3	2
	60W	16	12	9	8	5	4	3
	96W	25	19	15	12	8	7	5
	90W	24	18	14	12	8	7	5
	2X90W	48	36	28	24	16	14	10
	3X90W	72	54	43	36	24	21	15
	100W	26	20	16	12	8	8	5
	2X100	53	40	32	26	17	16	11

# TARGETTI

## SATURN MINI

### Photometrics

