

TARGETTI

CCT LED ARCHITECTURAL MINI CLASS II

4" Professional Fixed LED Downlight

Concept: Professional single COB LED in small aperture (4") recessed fixed downlight.

Materials: Painted Black die-cast aluminium heat sink and White polycarbonate body.

Trim Accessories: Multiple styles and finishes of matte polycarbonate trims and secondary reflectors available.

Optics: Primary optical assembly complete with metal precision optic with convex facets (MW) or methacrylate lens (FL).

Mounting: Tool-free spring-clip mounting system. Decorative trim ring mounted after fixture installation with twist lock attachment.

Driver: Remote driver available as EldoLED 0-10V dimmable drivers.

Wattage: 9W standard

Color Temperature: 2700K and 3000K standard

IP Rating: Damp Location

Certifications: Class 2 UL2108

Tested in accordance with LM-79-08

Warranty: 5 year limited warranty



Lumens:	3000°K	2700°K
	9W	9W
Spot 15° =	572Lm	543Lm
Flood 30° =	791Lm	752Lm
Medium Wide Flood 45° =	914Lm	869Lm

PRODUCT CODE	DRIVER	OPTICS	WATTAGE	COLOR TEMP	CRI	+	DRIVER	+	TRIM & REFLECTOR
CCM-F Arc Mini Fixed	RP — Remote Power	SP — Spot 15° w/diffusion lens	L1 — 9W	27 — 2700K	84 — 84 CRI		Required		Required
		FL — Flood 30° w/diffusion lens		30 — 3000K			(See Pg 2)		(See Pg 2)
		MFL — Medium Wide Flood 45°							

Views

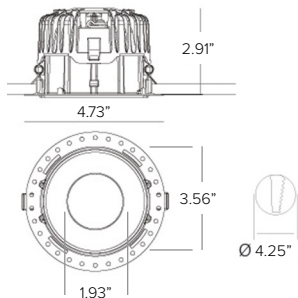

CCT LED ARCHITECTURAL MINI CLASS II

DRIVER (REQUIRED)	
PS004	EldoLED Eco Drive Class II Power Supply, Universal 120-277VAC Input, 10W 220mA 0-10V Dimmable to 1%
PS006	Phase Dimmable Class II Power Supply, 120VAC Input, 16W 220mA Dimmable to 15%

Consult factory for additional driver options.

TRIM (REQUIRED)	
1T4696	Round White Trim
1T4697	Round Black Trim
1T4698	Square/Round White Trim
1T4699	Square/Round Black Trim
1T4700	Pinhole White
1T4701	Pinhole Black
1T4704	Round IP54, White
1T4705	Round IP54, Black



1T4696



1T4697



1T4698



1T4699



1T4700



1T4701



1T4704



1T4705

SECONDARY REFLECTOR (REQUIRED) * Factory Installed	
1T4706	White
1T4707	Black
1T4708	Copper
1T4709	Gold
1T47SF	Silver



Secondary Reflector

ACCESSORIES	
49881	Chromatic Filter - Red
49882	Chromatic Filter - Green
49886	Chromatic Filter - Blue
49887	Chromatic Filter - Yellow
49959	Chromatic Filter - Magenta
1T1745	Cold Tone Filter
1T1748	Gold Tone Filter
1T1751	Peach Tone Filter
1T4721	Blade of Light Filter
1T4322	Honeycomb Louver
1T4324	Zoom



Chromatic Filter



Tone Filter

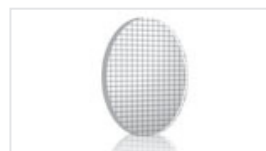

1T1745



1T1748



1T4324

TARGETTI

CCT LED ARCHITECTURAL MINI CLASS II

Photometric Information

SPOT		POLAR GRAPH		CONE OF LIGHT																			
Fixture Power	9W				<table border="1"> <thead> <tr> <th>(Ft)</th> <th>Max</th> <th>Med</th> </tr> </thead> <tbody> <tr> <td>2.00</td> <td>1811</td> <td>1191</td> </tr> <tr> <td>4.00</td> <td>453</td> <td>298</td> </tr> <tr> <td>6.00</td> <td>201</td> <td>132</td> </tr> <tr> <td>8.00</td> <td>113</td> <td>74</td> </tr> <tr> <td>10.00</td> <td>72</td> <td>48</td> </tr> </tbody> </table>	(Ft)	Max	Med	2.00	1811	1191	4.00	453	298	6.00	201	132	8.00	113	74	10.00	72	48
(Ft)	Max	Med																					
2.00	1811	1191																					
4.00	453	298																					
6.00	201	132																					
8.00	113	74																					
10.00	72	48																					
Fixture Output	543Lm	572Lm																					
Kelvin Temp	2700°K	3000°K																					
Beam Spread	SP 15°	SP 15°																					
I _{Max}	9468cd/klm	9468cd/klm																					
Efficacy	60 Lm/W	64 Lm/W																					

FLOOD		POLAR GRAPH		CONE OF LIGHT																			
Fixture Power	9W				<table border="1"> <thead> <tr> <th>(Ft)</th> <th>Max</th> <th>Med</th> </tr> </thead> <tbody> <tr> <td>2.00</td> <td>726</td> <td>463</td> </tr> <tr> <td>4.00</td> <td>182</td> <td>116</td> </tr> <tr> <td>6.00</td> <td>81</td> <td>51</td> </tr> <tr> <td>8.00</td> <td>45</td> <td>29</td> </tr> <tr> <td>10.00</td> <td>29</td> <td>19</td> </tr> </tbody> </table>	(Ft)	Max	Med	2.00	726	463	4.00	182	116	6.00	81	51	8.00	45	29	10.00	29	19
(Ft)	Max	Med																					
2.00	726	463																					
4.00	182	116																					
6.00	81	51																					
8.00	45	29																					
10.00	29	19																					
Fixture Output	752Lm	791Lm																					
Kelvin Temp	2700°K	3000°K																					
Beam Spread	FL 30°	FL 30°																					
I _{Max}	2627cd/klm	2627cd/klm																					
Efficacy	84 Lm/W	88 Lm/W																					

MEDIUM WIDE FLOOD		2700°K	3000°K	POLAR GRAPH		CONE OF LIGHT																	
Fixture Power	9W				<table border="1"> <thead> <tr> <th>(Ft)</th> <th>Max</th> <th>Med</th> </tr> </thead> <tbody> <tr> <td>2.00</td> <td>372</td> <td>224</td> </tr> <tr> <td>4.00</td> <td>93</td> <td>56</td> </tr> <tr> <td>6.00</td> <td>41</td> <td>25</td> </tr> <tr> <td>8.00</td> <td>23</td> <td>14</td> </tr> <tr> <td>10.00</td> <td>15</td> <td>9</td> </tr> </tbody> </table>	(Ft)	Max	Med	2.00	372	224	4.00	93	56	6.00	41	25	8.00	23	14	10.00	15	9
(Ft)	Max	Med																					
2.00	372	224																					
4.00	93	56																					
6.00	41	25																					
8.00	23	14																					
10.00	15	9																					
Fixture Output	869Lm	914Lm																					
Kelvin Temp	2700°K	3000°K																					
Beam Spread	MFL 45°	MFL 45°																					
I _{Max}	1372cd/klm	1372cd/klm																					
Efficacy	97 Lm/W	102 Lm/W																					