

TARGETTI

STORE MINI DOUBLE GIMBAL CLASS II

Adjustable Recessed LED Projector Downlight

Concept: Professional single COB LED in small aperture 3" recessed adjustable downlight.

Materials: Painted die-cast aluminium projector body and external ring. Polycarbonate internal ring. Available in black and white. Gimbal System to adjust the optical unit 30° vertically and 355° horizontally.

Optics: Primary optical assembly complete with metal precision optic with convex facets (SP, FL and MWF) or methacrylate lens (NS) only.

Mounting: Plentum accessible removable plasterframe with tool-free spring-clip mounting system.

Driver: Remote driver available as Electronic Phase or 0-10V dimmable. Also available with EldoLED 0-10V, Eco (1%) and Solo (0.1%) dimmable drivers

Wattage: 5W and 13W standard

Color Temperature: 3000K and 4000K standard

Lumen Maintenance (L70): 50,000hrs

Calculation for LED fixtures are based on measurements that comply with IES LM-80.

IP Rating: Damp Location

Certifications: Class 2 UL2108

Tested in accordance with LM-79-08

Warranty: 5 year limited warranty



Lumens:	5W		13W	
	3000K	4000K	3000K	4000K
Narrow Spot 9°	= 116Lm	123Lm	–	–
Spot 15°	= –	–	889Lm	928Lm
Flood 30°	= –	–	1199Lm	1239Lm
Medium Wide Flood 48°	= –	–	1386Lm	1432Lm

PRODUCT CODE	FIXTURE COLOR	DRIVER	GIMBAL	FIXTURE 1		FIXTURE 2	
				OPTICS	WATTAGE	OPTICS	WATTAGE
STMG – STORE Mini Gimbal	PW – Plaster White	RP – Remote Power	2X – 2X Double	NS – Narrow Spot 9°	L1 – 5W	NS – Narrow Spot 9°	L1 – 5W
	DB – Deep Black			SP – Spot 15°	L2 – 13W	SP – Spot 15°	L2 – 13W
				FL – Flood 30°		FL – Flood 30°	
				MW – Medium Wide Flood 48°		MW – Medium Wide Flood 48°	

see below for continued spec

COLOR TEMP	CRI	+	FRAME & DRIVER
30 – 3000K	84 – 84 CRI		See Page 2
40 – 4000K			

Views

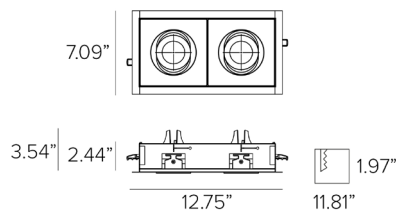

TARGETTI

STORE MINI DOUBLE GIMBAL CLASS II

FRAME (REQUIRED)	
1T6427	Frame 2X Double White Finish
1T6424	Frame 2X Double Black Finish

DRIVER (REQUIRED)			
		Driver Quantities	
		NS	SP, FL, MF
PS001	EldoLED Eco Drive Power Supply, Universal 120-277VAC Input, 10W 900mA 0-10V Dimmable to 1%	2X	
PS002	EldoLED Eco Drive Power Supply, Universal 120-277VAC Input, 20W 350mA 0-10V Dimmable to 1%		2X

Consult factory for additional driver options.

ACCESSORIES	
49881	Chromatic Filter - Red
49882	Chromatic Filter - Green
49886	Chromatic Filter - Blue
49887	Chromatic Filter - Yellow
49959	Chromatic Filter - Magenta
1T1745	Cold Tone Filter
1T1748	Gold Tone Filter
1T1751	Peach Tone Filter
1T4721	Blade of Light Filter
1T4322	Honeycomb Louver
1T4325	Asymmetric Screen
1T4324	Zoom



Chromatic filters



Tonal filters



1T4721

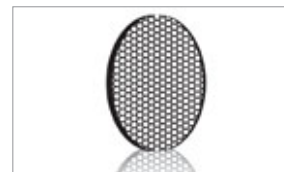

1T4322



1T4325



1T4324

TARGETTI

STORE MINI DOUBLE GIMBAL CLASS II

Photometry

NARROW SPOT			POLAR GRAPH		CONE OF LIGHT					
Fixture Power	5W	5W			(Ft)	Alpha=4.3°+4.3°	G=0.0°	Beta=4.3°+4.3°	Max	Med
CRI	84 CRI	84 CRI			5.00				ftcd	ftcd
Fixture Output	163Lm	173Lm			10.00				188	124
Kelvin Temp	3000°K	4000°K			15.00				47	31
Beam Spread	NSP 9°	NSP 9°			20.00				21	14
I _{Max}	22178cd/klm	22178cd/klm			25.00				12	8
Efficacy	33 Lm/W	35 Lm/W							8	5

SPOT			POLAR GRAPH		CONE OF LIGHT					
Fixture Power	13W	13W			(Ft)	Alpha=7.0°+7.0°	G=0.0°	Beta=7.0°+7.0°	Max	Med
CRI	84 CRI	84 CRI			6.00				ftcd	ftcd
Fixture Output	889Lm	928Lm			12.00				313	206
Kelvin Temp	3000°K	4000°K			18.00				78	51
Beam Spread	SP 14°	SP 14°			24.00				35	23
I _{Max}	9470cd/klm	9470cd/klm			30.00				20	13
Efficacy	68 Lm/W	71 Lm/W							13	8

FLOOD			POLAR GRAPH		CONE OF LIGHT					
Fixture Power	13W	13W			(Ft)	Alpha=14.0°+14.0°	G=0.0°	Beta=15.0°+15.0°	Max	Med
CRI	84 CRI	84 CRI			5.00				ftcd	ftcd
Fixture Output	1199Lm	1239Lm			10.00				178	112
Kelvin Temp	3000°K	4000°K			15.00				44	28
Beam Spread	Flood 30°	Flood 30°			20.00				20	12
I _{Max}	2627cd/klm	2627cd/klm			25.00				11	7
Efficacy	92 Lm/W	95 Lm/W							7	4

MEDIUM WIDE FLOOD			POLAR GRAPH		CONE OF LIGHT					
Fixture Power	13W	13W			(Ft)	Alpha=24.0°+24.0°	G=0.0° Max not at G	Beta=24.0°+24.0°	Max	Med
CRI	84 CRI	84 CRI			5.00				ftcd	ftcd
Fixture Output	1386Lm	1432Lm			10.00				90	54
Kelvin Temp	3000°K	4000°K			15.00				23	14
Beam Spread	MWF 48°	MWF 48°			20.00				10	6
I _{Max}	1372cd/klm	1372cd/klm			25.00				6	3
Efficacy	106 Lm/W	110 Lm/W							4	2